

**NEW ENGLAND RURAL HEALTH ASSOCIATION**  
*Fall 2023 Conference Program*

**NEW HORIZONS IN RURAL HEALTH EQUITY**





NEW ENGLAND RURAL HEALTH ASSOCIATION

NERHA.ORG

### OUR STAFF

**Andy Lowe**  
Executive Director

**Ann Marie Day**  
Chief Operatng Officer

**Kiera Hight**  
Executive & Member Services Coordinator

**Ezekiel Baskin**  
Rural Health Program Manager

**Jenn McCarthy**  
Grant Manager

**Aisling Ryan-Abbott**  
Consultant

**LeeAnn Waye**  
Consultant

**Kiara Badillo**  
Consultant

### BOARD OF DIRECTORS

#### EXECUTIVE COMMITTEE

**President:**  
**Lora Gerard**  
Dartmouth Centers for Health and Aging

**President Elect:**  
**Michael Pancook**  
Independent Consultant - Health Policy & Non-profit Business Intelligence

**Secretary:**  
**Luca Fernandez**  
Vermont Department of Health

**Treasurer:**  
**Kirby Lecy**  
MA Dept of Public Health

**Member-At-Large:**  
**Jeffery Waldron**  
Franklin Pierce Masters PA Program

#### CONNECTICUT

**Lori Fedewa (ex-officio)**  
CT State Office of Rural Health

**T.J Clarke II**  
Connecticut Oral Health Initiative, Inc.

**Justin Hamrick**  
Connecticut Department of Public Health

#### MAINE

**Nicole Breton (ex-officio)**  
ME State Office of Rural Health

**Dr. Sue Woods**  
Physician iMAT Hub, Southern Maine Health Care

**Micaela Maynard**  
University of New England

#### MASSACHUSETTS

**Cathleen McElligott (ex-officio)**  
MA State Office of Rural Health

**Kim Jaszlics Savery**  
Hilltown Community Health Centers

#### NEW HAMPSHIRE

**Shawn Jackson (ex-officio)**  
NH State Office of Rural Health

**Ann Turner**  
Intergrated Healthcare

**Sharon O’Conner**  
Dartmouth College

#### RHODE ISLAND

**Manny Ortiz (ex-officio)**  
RI State Office of Rural Health

**Alison Warfel**  
Block Island Health Services

#### VERMONT

**John Olson (ex-officio)**  
VT State Office of Rural Health

**Roberta diFlori-Alexander**  
Dartmouth-Hitchcock Medical Center/Geisel School of Medicine at Dartmouth Services

#### OUTGOING BOARD MEMBERS

**Elizabeth Winterbauer**  
Vermont Analysis and Programming Services

**Stephen Martin**  
UMASS Medical School

**Jeffrey Dodge**  
Private Practice

### Executive Director’s Welcome

Welcome to the New England Rural Health Association (NERHA) 2023 Annual Conference! This year we return to beautiful Killington, Vermont to celebrate rural health and wellness with our members, colleagues, friends, sponsors and partners. This year’s theme, New Horizons in Rural Health Equity, was chosen by our Conference Committee as a timely reflection on the challenges in rural health equity and innovative solutions that can help address them. “Health equity,” like any phrase that comes into frequent usage, seems to be expanding in scope as an incredibly broad concept: race, ethnicity, gender identity, age, socio-economic status, disability, access, education, culture, language, mobility, nationality... The list can be virtually endless, making a precise, concise definition hard to find. Perhaps, rather than defining equity, it would be helpful to think about equity as a goal. The World Health Organization says, “Health equity is achieved when everyone can attain their full potential for health and well-being.” Not bad. I think our NERHA vision aligns pretty well: “We envision a rural New England in which all people have equitable pathways to health including complete physical, mental, and social well-being.”

During this conference, you will have an unparalleled opportunity to sample presentations, posters, panels, and people that examine just about every angle of rural health. Our Plenary Panel of Vermont experts will discuss challenges in health equity and innovative ways of meeting the challenge. Our famous Federal Panel will talk about funding and policy trends to elevate health equity. We have presentations that span a gamut of topics from ageism to telepsychiatry to transportation to workforce to hepatitis C and far, far beyond. How about a music teacher turned rural health network coordinator... A rural county-wide baby shower... Ambulance deserts... Recovery ecosystems... Oral health navigators... Hospital hair equity... Progressive policing approaches to community wellness... and I’ve still only scratched the surface. Maybe your interest is academic, clinical, or operations. We have ACOs and value-based care. Translational research. Rural GME. Cardiovascular and stroke care quality. Tele-urgent care. I’ve still only begun. Did I mention that we have presenters bringing insights from beyond New England? Tennessee, Colorado, North Carolina, and Kentucky are all represented. Unless you’ve mastered the art of being in several places at once, your only problem will be deciding among all the offerings!

Then there’s the networking. We are offering our first Student Mixer for medical, nursing, public health and other students who are interested in rural practice. During breaks, breakfast, lunch, dinner, après dinner, we invite you to mingle and meet and connect and re-connect with new and old friends and colleagues and partners. Establish and rekindle collaborative relationships. Find opportunities to work together on future grants or research. Learn. Laugh. Relax.

I would be remiss not to honor our sponsors who help make it all happen. I can’t name a few without naming them all. Please visit them. They are here to educate you, and you will absolutely learn from the experience. They are truly valued partners and their contribution is vital.

So again, welcome. It’s all here, under one roof, the most comprehensive forum on rural health and wellness in New England. One of our NERHA central strategic pillars is to be a trusted convener, and this is our flagship event. It’s the result of literally a year of hard work by our staff, Conference Committee, Board, sponsors and partners throughout New England. Our goal is to make this conference the best forum on rural health and wellness in the country. I think we’ve succeeded, and I hope you’ll agree. Enjoy!

Andy Lowe  
Executive Director



We are a non-profit, membership-driven organization that serves as a regional rural health advocate. Our mission is to improve the health and wellbeing of communities throughout rural New England.

## ON-SITE NETWORKING OPPORTUNITIES AND LOBBY HOURS

A first time attendee or seasoned veteran? Have no plans or an unexpected break? Join us in the Lobby for unlimited networking with colleagues and exhibitors while taking a break from sessions.

### Wednesday, Nov. 8th

**10:00 - 11:30**

Check-In Opens

**11:30 - 1:15**

Lunch & Welcome

**1:15 - 5:30**

Sessions

**6:30 - 8:00**

Dinner Reception

### Thursday, Nov. 9th

**7:00 - 8:30**

Breakfast

**8:30 - 11:30**

Sessions

**11:30 - 12:30**

Lunch & NERHA Member Meeting

**12:30 - 3:30**

Sessions

**3:45 - End**

Closing Remarks & Prize Drawing

## SOCIAL MEDIA | CONNECT WITH NERHA



Join in the most collaborative rural health association on NERHA's Member Exchange community.



Take and upload photos on the NERHA Facebook page.

# NEW HORIZONS IN RURAL HEALTH EQUITY

## NERHA's 2023 Annual Fall Conference

### About NERHA

The New England Rural Health Association was established in 1997 with funding from the National Rural Health Association. The Association serves as the rural health association for the six New England states. We are a non-profit, membership-driven organization that serves as a regional rural health advocate.

Now headquartered in Vermont, the Association has grown to a staff of five and five consultants, and is governed by a Board of Directors. Our organization includes over 400 members from across the region who are also committed to improving the health and wellbeing of our rural communities. Together, our staff, consultants and Board work on behalf of our members to advance the work of the New England Rural Health Association and improve the health of rural New Englanders.

If you need assistance, feel free to contact us with questions, suggestions, and concerns. We appreciate your input, and are always looking for new ways to help rural communities and organizations throughout New England.

You can help NERHA in fulfilling its mission. Please consider joining one of our committees or nominating others or yourself for open Board seats.

### Mission

To improve the health and wellbeing of the people and communities throughout rural New England.

### Vision

We envision a rural New England in which all people have equitable pathways to health including complete physical, mental, and social wellbeing.

### EVALUATION FORMS & SURVEYS

Please let us know how we are doing and the value of this conference! Evaluation forms and surveys will be emailed to all attendees after the conference.

### MEMBER EXCHANGE

We have created an online community platform to allow our members to take advantage of the collaborative opportunities NERHA can provide through our network.

With NERHA's Member Exchange site, you can collaborate with peers to share strategic advice, solve challenges and develop new approaches that address your organization's rural health needs.

We have a variety of communities available for you to use to connect with your peers, including the Open Forum, Student & Workforce Training Network, Oral Health, etc. You can also make direct connections with others by region or profession, share resources and media, and a whole lot more!

### ELECTRONIC DEVICES

While we encourage you to check out the Member Exchange, as a courtesy to speakers and session attendees, please silence or turn off all electronic devices during sessions. For important calls and for your own privacy, please step out of the room and away from meeting room doors so you do not disturb fellow members.

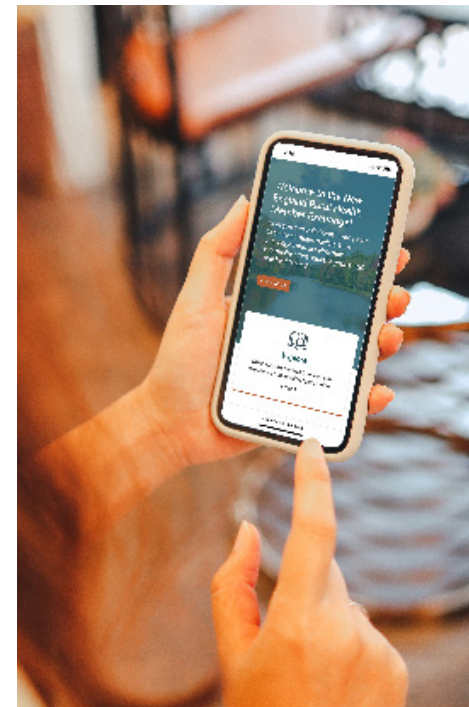

Our Wonderful Board & Team

# CONFERENCE AGENDA

Welcome to the 2023 New England Rural Health Association Conference in magnificent Killington, Vermont! This year's theme is New Horizons in Rural Health Equity. We hope that you will have a fulfilling experience and gain valuable insights during your time with here with us!

## WEDNESDAY, NOV. 8TH

9:30 - 11:30	* NETRC & Care2 Pre-Conference Event
10:00 - 11:30	Check-In Opens
11:30 - 12:45	Lunch & Explore Exhibitors
12:45 - 1:15	Welcome
1:15 - 2:30	Vermont Plenary Panel Session
2:30 - 3:00	Break, Exhibitors & Snacks
3:00 - 4:00	Breakout Sessions
4:00 - 4:30	Break, Exhibitors & Snacks
4:30 - 5:30	Breakout Sessions
4:30 - 5:30	** Student Mixer
6:00 - 6:30	State Community Star Awards & State Office of Rural Health Meet & Greet
6:30 - 8:00	Reception, Small Plate Dinner

## THURSDAY, NOV. 9TH

7:00 - 8:30	Check-In, Breakfast & Kick Off
8:30 - 9:30	Breakout Sessions
9:30 - 10:00	Break, Exhibitors & Snacks
10:00 - 11:30	Federal Panel & Fireside Chat
11:30 - 12:30	Lunch & NERHA Member Meeting
12:30 - 1:00	Poster Presentation Session
1:00 - 2:00	Breakout Sessions
2:00 - 2:30	Break & Snacks
2:30 - 3:30	Breakout Sessions
3:45 - End	Closing Remarks & Prize Drawings

### New Conference Events



\* In order to attend this event you must have registered for it in advance.

\*\* We welcome all students to attend and participate in the activities. Please keep in mind that this event will be held in the Preston Restaurant & Bar which has limited space.

# PLENARY SESSION

WEDNESDAY AT 1:15-2:30PM

Explore a dynamic discussion featuring industry leaders and experts as they share insights and engage in thought-provoking discourse during this must-attend Plenary Panel session, set in the grand ballroom on Wednesday from 1:00 PM to 2:00 PM.



## KARI WHITE NORTHERN COUNTIES HEALTH CARE

Kari White (Pronounced: KAHR-ee WIEt (hear name)) (she/her) is the Director of Community Health Equity at Northern Counties Health Care in the Northeast Kingdom of VT where she has worked for the past 11 years including seven as the Director of Quality and Compliance and Privacy Officer. In her current role, Kari serves as the leader of two Collective Impact Accountable Health Communities: NEK Prosper! (est. 2013) and Vibrant ONE (est. 2021).

Kari brings 15+ years of strategic community health leadership working with partners at the national, state, and local level to claim identity and context expertise within health systems change initiatives.

Her focus is on centering equitable practice, resource allocation, relationship and power sharing through inclusive design, creative and play-based engagement, and aligned action.

Kari holds credentials in Results-Based Accountability and Leadership (Annie E. Casey Foundation), Complex Facilitation (Conversation Factory), Advanced Systems Thinking (Waters Center) and as an ACE Interface / Building Flourishing Communities Master Trainer and Community Resilience Coach. Kari serves on multiple State and local committees, as the Northeast Kingdom Human Services Board Vice President and is the Co-founder of the Neurodivergent Professionals Working Group. When not working, you will often find Kari researching special interests (currently the intersection of neurodivergence, gender, mental health and increased morbidity and mortality), playing games, or dancing around the old farmhouse of her dreams/nightmares with her supportive fourth grade teacher husband and four incredible kids.



## PATRICE KNAPP RN, MSN, CPHQ STRATEGIC QUALITY

Patrice joined the Vermont Program for Quality in Health Care (VPQHC) team in 2011 serving as the Director of Quality until 2014, and returned in February 2022 to provide consultative Quality Improvement expertise. Her tenure as the Director of Quality at Central Vermont Medical Center from 2014-2022 provides relevant experience in all acute and long-term care quality functions. She brings the voice of the field, demonstrated quality methodology competency, and a strong knowledge base related to patient safety, performance improvement, regulatory readiness, and project management.

She earned certification as a PROSCI change management professional and has maintained the Certified Professional in Health Quality credential since 2011. Her long career as a master's prepared Registered Nurse keeps her grounded in compassionate and safe patient centered care. Patrice supports the VPQHC team on a variety of quality improvement initiatives and partnerships to continuously improve health care for all Vermonters.



# NEW HORIZONS IN RURAL HEALTH EQUITY

## NERHA's 2023 Annual Fall Conference



### RUDOLPH (RUDY) FEDRIZZI, MD VT DEPARTMENT OF HEALTH

Rudolph (Rudy) Fedrizzi, MD has been the Public Health Services District Director for the White River Junction Office of Local Health (OLH) in the VT Department of Health since 2019. Dr. Fedrizzi previously practiced Obstetrics and Gynecology for 16 years, most recently as a partner in Every Woman's Care, PLLC in Ithaca, NY (2005-2009). His past administrative and clinical experience includes Chief of OB-GYN Services and training as a flight surgeon at Luke Air Force Base Hospital in Glendale, AZ (1993-1997 – Rank of Major) and Medical Director of the Northern New Mexico Women's Health and Birth Center in Taos, New Mexico (1997-2003). He holds a Vermont medical license.

In early 2010, he transitioned to the non-clinical role of Director of Clinical Integration in the Center for Population Health at Cheshire Medical Center/Dartmouth-Hitchcock, a community hospital and multi-specialty physician practice located in Keene, NH. He held this position until 2018. In that role he took the lead in organizing integration efforts that purposefully and proactively link clinical services with community health partners and resources. He served as a core member of the Healthy Monadnock Initiative project team that ensured continuing progress on the goal of the Initiative to make the Monadnock Region of southwestern NH the healthiest community in the nation. He also served as a member of Cheshire Medical Center's Accountable Care Organization Leadership Team and chaired the organization's Research Committee helping to facilitate collaborative research efforts involving the medical campus and academic partners. He actively refined and promoted a Clinical Integration model and regularly shared case examples of Integration projects with local, regional, and national audiences through articles, conferences, and webinars.

Currently, he is Chair of the Leadership Council of the Dartmouth Center for Advancing Rural Health Equity, Chair of the Upper Valley Medical Reserve Corps Advisory Board, Immediate past-President of the Public Health Council of the Upper Valley Board, Vice President of the Southern NH AHEC Board, and a member of the Twin Pines Housing Trust Board. He is a member of the American Public Health Association.

He has three children, Julianna (30), Peter (27) and Ellie (18). He is an avid reader, whimsical birdhouse builder, and reasonably consistent runner.



### NAOMI WOLCOTT-MACCAUSLAND UVM, MIGRANT HEALTH

Naomi Wolcott-MacCausland leads Migrant Health Programs with the University of Vermont Extension. She manages a portfolio of grants and initiatives that facilitate migrant and immigrant health access and equity. Recognizing the lack of connection to health services in the population of workers that Naomi supported through a role in Migrant Education, she designed Bridges to Health - Migrant Health Program's flagship initiative that utilizes Community Health Workers to improve access to health and social services for migrant and immigrant workers and their families across Vermont. The program now includes a staff of 10 that do outreach work across the state of Vermont. Naomi also established and co-directs Huertas, a

community-based garden project working to increase food security and access to culturally familiar foods with migrant farmworker households. She holds a Master's Degree in Community Development and Applied Economics from UVM. Naomi is fluent in Spanish after living for four years in Central America including two years with the Peace Corps in El Salvador.

# FEDERAL PANEL

THURSDAY AT 10-11:30AM

On the second day join us for two ways to learn from and network with our Federal partners. We will start with a facilitated panel discussion and then take a deeper dive with a fireside chat for more informal discussions.

## Federal Panelist

## Bio



**Christopher Bersani, Psy.D., ABPP**  
Region 1—HRSA Office of Regional Operations  
cbersani@hrsa.gov

Captain Christopher Bersani is a Clinical Health Psychologist and Neuropsychologist by training and currently serves as the Deputy Regional Administrator and the National Lead for Behavioral Health for the Office of Intergovernmental and External Affairs (IEA) of HHS' Health Resources and Services Administration (HRSA).

Captain Bersani has spent the last 15 years working for HRSA where, in addition to providing regional oversight for HRSA grants and programs, he has been the regional and national leader for behavioral health activities and programs for HRSA's regional offices.



**Lolita McLean, DrPH, MPH**  
HRSA Maternal and Child Health Bureau (MCHB), Region 1  
LMcLean@hrsa.gov

Lolita McLean is a public health analyst for the Health Resources and Services Administration (HRSA)/Maternal and Child Health Bureau (MCHB) in Region 1 (Connecticut, Massachusetts, Maine, New Hampshire, Rhode Island, and Vermont). At HRSA/MCHB, Lolita is a project officer in the Division

of State and Community Health (DSCH) -Title V Maternal and Child Health Services Block Grant Program. As one of the largest federal block grant programs, Title V is a key source of support for promoting and improving the health and well-being of the nation's mothers, children, including children with special needs, and their families.



**Humberto M. Carvalho, MPH**  
Substance Abuse & Mental Health Services Administration-SAMHSA  
Humberto.Carvalho@samhsa.hhs.gov

Humberto Carvalho, MPH - Humberto Carvalho is a Public Health Advisor under the National Mental Health and Substance Use Policy Laboratory (Policy Lab) from SAMHSA, with more than 25 years of experience in the public health field. He has worked domestically and internationally in several projects funded by the US government.

Humberto holds a Master's in Public Health with concentration in Epidemiology from UNC Chapel Hill and he has been with SAMHSA for almost 11 years.

## Federal Panelist

## Bio



**Michael Fallahkhair**  
HRSA Federal Office of Rural Health Policy (FORHP)  
MFallahkhair@hrsa.gov

Michael Fallahkhair, MPH, is the Principal Advisor for Impact and Planning for the Federal Office of Rural Health Policy (FORHP) in the Health Resources and Services Administration of the U.S. Department of Health and Human Services (HHS). In this role, Mr. Fallahkhair helps to lead the work of FORHP, which

is charged with advising the Secretary of HHS on rural health issues and improving the delivery of rural health care. Mr. Fallahkhair previously served as the Executive Officer in the HHS Immediate Office of the Secretary and as Deputy Director of the Community-Based Division in FORHP. Mr. Fallahkhair has past work experience in the Office of Budget of the Assistant Secretary for Financial Resources at HHS and the Office of Management and Budget. Mr. Fallahkhair has an undergraduate degree in Neurobiology and Physiology from the University of Maryland at College Park and a Master's in Public Health with a concentration in Health Policy from George Washington University.



**Sarah Heppner**  
Associate Director of the Federal Office of Rural Health Policy (FORHP)  
sheppner@hrsa.gov

Sarah Heppner serves as the Associate Director of the Federal Office of Rural Health Policy (FORHP) in the Health Resources and Services Administration (HRSA) of the U.S. Department of Health and Human Services (HHS). In this role, Sarah provides programmatic, policy, and operational support for the Office. Sarah

has been with FORHP since 2012, serving as the Research Coordinator, the Deputy Director of the Office for the Advancement of Telehealth, and the Director of the Policy Research Division. She has an undergraduate degree in chemistry from Wells College and a Master's in Clinical and Translational Sciences with a concentration in Research Management from the University of Vermont.



**Everett Handford MBA**  
Regional Director, Region 1, US Department of Health and Human Services  
Everett.Handford@hhs.gov

Everett Handford joined the U.S. Department of Health and Human Services from the Commonwealth of Massachusetts, appointed by President Joe Biden on 5 January 2023. He previously served as the Deputy State Director for United States Senator Elizabeth Warren (D-MA). Handford oversaw Senator Warren's state

operations, constituent services portfolio, and political outreach. Prior to working for Senator Warren, Handford was a brand management consultant for professional athletes. Handford received his Master's Degree from the University of Southwest in Hobbs, New Mexico in Public Health Administration, a Business Certificate from Northeastern University in Boston, Massachusetts, and a BA in Science from Johnson & Wales University in Providence, RI.



**Grant McElwee, PharmD, MSHI, BCPS, CPH**  
Outreach Specialist, Office of Program Operations and Local Engagement, CMS  
Grant.McElwee@cms.hhs.gov

Grant McElwee is the Provider Outreach Specialist and Rural Health Coordinator for the Centers for Medicare & Medicaid Services (CMS) Boston regional office, where he joined the team in November 2022. Grant is a pharmacist by training and received his Doctor of Pharmacy (PharmD) degree from the University of Arkansas for Medical Sciences College of Pharmacy in 2010. Grant was commissioned as

an officer in the United States Public Health Service in 2011. Prior to joining the team at CMS in Boston, Grant lived in Tulsa, OK, where he served in multiple pharmacy roles with the Indian Health Service at a rural facility in north-central Oklahoma for 12 years. Grant also has a passion for informatics and received his Master in Health Informatics (MSHI) degree from the University of Illinois Chicago in 2018.

# BREAKOUT SESSIONS

WEDNESDAY - THURSDAY

Join us for our engaging breakout sessions where you can dive deep into exciting topics. Many of our sessions feature two related presentations followed by a joint Q&A and discussion. Our esteemed speakers will share their expertise, offering valuable insights and fostering interactive discussions. Don't miss this opportunity to expand your knowledge and connect with rural health thought leaders.

Wednesday, November 8th, 3:00 PM - 4:00 PM

## Northstar 1

### Transform your Recruitment Marketing to Attract Today's Workforce

This session will cover important areas to consider when developing a recruitment marketing plan from building your team of champions to assessing your strengths and challenges, as well as crafting effective job advertisements.

*Mandi Gingras, Director of Education, 3RNET*

### I Lead, You Lead, We All Lead: An Appreciative Inquiry Approach to Improving Organizational Leadership

Discover Appreciative Inquiry, a positive approach to leadership development and organizational change. Learn how skilled leaders play a crucial role in ensuring equitable access to rural healthcare while also thinking about the Social Determinants of Health (SDOH). Join this interactive session to assess, reflect, and enhance your organization's leadership capacity.

*Judiann Smith, Executive Director, Daniel Hanley Center for Health Leadership & Janell Lewis, Director of Leadership Development Education, Daniel Hanley Center for Health Leadership*

## Gateway

### MOSAIC: See the Big Picture of Health Equity/Join the Conversation

MOSAIC captures conversations about racism and health with leaders of color across Western Massachusetts including our wonderful rural counties. These leaders are paving the way toward healthier communities and advocating for equity, justice, representation, and transformation. Includes poetry and highlights the Women of Color Health Equity Collective, Estoy Aqui, Multicultural BRIDGE (Berkshires) and the Ohketeau Cultural Center (Ashfield)

*Risa Silverman, Outreach Director, University of Massachusetts Amherst School of Public Health & Health Sciences & Brenda Evans, Community Liaison, UMASS Center for Community Health Equity Research*

### More Than Just Hair: Improving Hair Care Equity at UVM Medical Center

The Hair Equity Project aims to diversify hair care products and train staff on inclusive hair care practices. Building on a model from Nationwide Children's Hospital, a team of UVM Medical Center employees are working to improve and create a more equitable care environment using quality improvement methodology.

*Alli Castile, Licensed Nursing Assistant, UVM Medical Center & Vanessa Rose, Monitoring Services Coordinator and BIPOC Employee Resource Co-Lead, The University of Vermont Medical Center*

Wednesday, November 8th, 3:00 PM - 4:00 PM

## Northstar 2

### Building a Community Hub Table (Responding together to those most at risk)

Every community has members who experience challenges and circumstances that put them, and others, at risk of harm. Building Community Hub Tables is a model to address the need to connect community members in need with the services and resources to mitigate risk and prevent harm from occurring.

*Amber Besaw, Executive Director, Northern Berkshire HUB Table & Jessi Byrne, Health & Wellness Coordinator, Northern Berkshire Community Coalition Inc*

### Reimagining Public Safety and Community Wellness: Collaborative Approaches

Public safety personnel are increasingly on the front lines of public health issues including substance use and mental health. In rural communities, collaborative approaches have been key in supporting residents. Learn how one police department partnered with an FQHC to improve access to services and support community wellness.

*Thomas Roda, Sergeant, Truro Police Department & Brianne Smith, Director of Care Management, Outer Cape Health Services*

## Escapade

### Ageism: A Blind-Spot in Rural Health Equity

Northern New Englanders are living longer, but our narratives about aging are often harmful. We must acknowledge how age-bias impacts our beliefs, interactions, work environment, and health systems. This interactive presentation will raise your awareness of ageism, and what we can do to build a more age-positive culture.

*Jess Maurer, Executive Director, Maine Association of Area Agencies on Aging & Angela Smith-Dieng, Director, Adult Services Division, Vermont Department of Disabilities, Aging and Independent Living & Anna Guest, Tri-State Learning Collaborative on Aging Project Manager, Maine Council on Aging*

### Social Isolation Among Older Adults - Rural Residents Have it Harder. What can be done?

Social Isolation has emerged as an issue of public health importance, well beyond the influence of the COVID-19 public health emergency. This session will address the findings of a NH study that examined the experience and impact of social isolation among older adults, especially those living in rural communities. It will discuss the populations most keenly affected, identify the services people turn to in order to increase socialization, identify barriers to access and inclusion, and propose programs and approaches that hold promise to engage those in greatest need.

*Margaret Franckhauser, Director of Aging Services, Aging Services at the Community Health Institute/JSI*

## Ballroom

### Building a Sustainable Framework for Community Health Workers in Vermont

Vermont Community Health Workers (CHWs) are actively engaged in unifying and advancing their profession by building a shared identity and a sustainable workforce infrastructure. Hear updates from Vermont Department of Health and findings from Southern Vermont Area Health Education Center (AHEC) from the CHW workforce initiative and learn what's next.

*Andrea Nicoletta, Health Equity Lead and CHW Coordinator, Vermont Department of Health & Katina Cummings, Project Director, VT CHW Workforce Initiative, Southern Vermont Area Health Education Center (SVTAHEC)*

### Oral Health Navigator: Creative Interprofessional Workforce Solution for Maine's School Oral Health Program

In rural Maine, accessing quality oral health care for children poses many challenges. This session highlights the pivotal role of the newly created Oral Health Navigator position, which aims to enhance the oral health workforce and improve children's access to quality oral health care across Maine.

*Kate Christiansen, RDH, IPDH, BA, Oral Health Program Manager, Maine CDC, State Office of Rural Health, Oral Health, and Primary Care & Sherry Laliberte, RDH, IPDH, BSDH, CDHC, School Oral Health Program Manager, MCD Global Health*



Wednesday, November 8th, 4:30 PM - 5:30 PM

### Northstar 1

#### Care Everywhere, Any Time - The Jackman Critical Access Physician Extender Tele-Urgent Care Program

What if you called 911 and everyone showed up? EMTs, paramedics, and physicians? And took care of your problem right there? In 2022, the Moose River Valley Community launched the Critical Access Physician Extender Program using Advanced Practice Paramedics to facilitate emergency physician tele-urgent care visits to do just that. *Jonnathan Busko, Medical Director, Care Delivery Transformation and Emergency Physician & Schyler Carpenter, Critical Access Integrated Paramedic, North East Mobile Health Services*

#### Vermont Emergency Telepsychiatry: A Work in Progress

The Vermont Emergency Telepsychiatry Network helps emergency departments provide timely psychiatric care via telehealth for people with mental health needs. We will profile one community hospital's collaboration with a local private psychiatric hospital and one critical access hospital's establishment of an after-hours emergency telepsychiatry service using a national vendor. *Ali Johnson, Quality Improvement Specialist, VPQHC & Alison Davis, Medical Director, Emergency Department, Rutland Regional Medical Center & Michael Rousse, Chief Medical Officer, Northeastern Vermont Regional Medical Center*

### Northstar 2

#### Partnering to Advance Rural Health Equity in Northern New England

To create meaningful and sustainable change, we must leverage new ways of working that put community needs and priorities at the center. Yet privilege, power, and systemic bias often hinder community partnerships and deepen existing inequities. Through examples of community-led partnerships with the Center for Advancing Rural Health Equity (CARHE), participants will leave with ideas to engage communities in designing and implementing programs that center on community priorities. *Chelsey Canavan, Manager, Center for Advancing Rural Health Equity & Angela Zhang, Programs Director, Listen Community Services*

#### The Northwest Connecticut Collaborative Addressing COVID-19 Health Disparities During the Global Pandemic

This session describes how community-based organizations and essential key partners collaborated to achieve key milestones to increase access to social services and medical care, including COVID-19 vaccines, testing, preventive care, and disease management, to at-risk populations, including racial and ethnic minorities, homebound and hard-to-reach residents. *Michelle Jose, Director of Nursing, Community Health & Wellness & Gina Burrows, Chief Operating Officer, Community Health & Wellness*

#### \*Student Mixer Session | 4:30-5:30PM at Preston's Restaurant & Bar

Featuring a short talk from 3RNET:  
**Your Career Compass: Defining & Charting the Best Course**

Discover the many resources available to help you define your job search priorities and guide you on building your network to support your career path in healthcare. *Mandi Gingras, Director of Education, 3RNET*



Wednesday, November 8th, 4:30 PM - 5:30 PM

### Gateway

#### Quaboag Connector: A Sustainable Model for Rural Transportation

Since 2017, the Quaboag Connector has provided accessible, affordable transportation to the rural Quaboag Valley area of Massachusetts. This session will explore the challenges that come with providing transportation in a rural area, potential models for navigating those challenges, and the impact that reliable transportation service has on rural communities. *Jen Healy, Rural Transit Program Manager, Quaboag Valley Community Development Corporation (QVDCD)*

#### A Regional Approach to Social Determinants of Health in Rural Communities: Using the AARP/WHO Livable Communities Framework

Explore a rural NH Initiative: Mount Washington Valley Age-Friendly Community. This regional partnership utilizes the AARP/WHO Livable Communities models to approach regional challenges to Social Determinants of Health. Serving the Mount Washington Valley region of NH, this regional partnership includes 11 NH towns and 1 ME town. *Caleb Gilbert, Director of Public Health, Carroll County Regional Public Health Networks & Marianne Jackson, Executive Director, Gibson Center for Senior Services*

### Escapade

#### Tying Rural Health Equity to Hospital Organizational Performance

What if focusing on Health Equity to satisfy Centers for Medicare & Medicaid Services requirements could also improve innovation, recruit and keep staff while improving community engagement and profitability? Come hear how the NH Foundation for Healthy Communities helped rural critical care hospitals do just that. *James McKim, Managing Partner, Organizational Ignition & Peter Gosline, President, PLG Healthcare Consulting*

#### How Rural Hospitals Can Leverage ACO Participation to Deliver High Value Patient Care

The transition from fee-for-service to value-based care is continuing to progress nationally, and pressure is steadily increasing for providers to be accountable for their costs and quality of care. Hear directly from healthcare leaders at Monadnock Community Hospital and Signify Health as they share how rural hospitals of all sizes and levels of resources can use ACO participation to deploy a team-based care approach where physicians, nurses, and front-line staff work in alliance to provide valuable preventive services, improve quality outcomes, and generate new revenue. *Daniel Perli, Chief Medical Officer, Monadnock Community Hospital & Richard Scheinblum, Executive Vice President-Administration & Chief Financial Officer, Monadnock Community Hospital & Aaron Valerio, Regional Vice President, Signify Health*

Join us at 4:30PM for a private student meet-up and networking event at the exquisite Killington Grand Resort Hotel, specifically at Preston's Restaurant & Bar. This is a fantastic opportunity to engage, socialize, and network with fellow students from schools of medicine, nursing, public health, and other programs across New England in a relaxed and welcoming atmosphere.

Whether you're a seasoned conference attendee or a first-time participant, this gathering promises to be a highlight of the event. It's a chance to connect with peers, share experiences, and foster meaningful relationships that can extend beyond the conference. Recent graduates will be on hand to give you the real story of what rural practice is like.

Thursday, November 9th, 8:30 AM - 9:30 AM

## Northstar 1

### **BRRAVVE North Quabbin**

Early in 2022, the North Quabbin Community Coalition embraced the challenge of addressing Diversity, Equity and Inclusion in a rural region. North Quabbin has been long defined as comprised of predominantly white, working class residents. The BRRAVVE NQ Task Force was designed to create a space for fluid dialogue around these topics. How does a community truly embed inclusion and equity in all aspects of living, working and playing? (Breaking Bias, Racial Justice, Rights for All, Ally-ship, Values, Voices for All, Equity)

*Heather Bialecki-Canning, Executive Director, NQCC, Inc. (North Quabbin Community Coalition)*

### **DEI in the Rural Context: An Emerging Story and Model in Progress.**

What does DEI look like in the rural context? This presentation will walk the audience through the process that the director of DEI has followed as she builds a model to address each point of DEI, centering all actions around the mission of centers. She will lay out her process of research, best evidence-based practices, community engagement and networking to provide a model from which any organization can start their own conversations about DEI and develop a commitment to growth where humans in their sphere can thrive.

*Debbie DiStefano, Director of DEI, Hilltown Community Health Center*

## Northstar 2

### **From Classrooms to Work Groups: A Teacher's Journey to Coordinating a Rural Health Network**

Can someone with no background in public health work in the field? What are the benefits of having a community member coordinating the expertise of various siloed agencies? Hear one person's story of leading with equity, learning on the fly, and adapting skills to support relationships across the Outer Cape.

*Alex Nelson, Network Coordinator, Outer Cape Community Solutions & Emily Beebe, Health and Conservation Agent, Town of Truro*

### **Addressing health-related social needs (HRSNs) in rural Maine communities through community partnerships.**

COVID-19 has affected rural communities in numerous ways, unmasking gaps in care, resulting from unmet health-related social needs. In this session, three rural Maine communities will share how they are working to bridge public health, healthcare and social service systems to leverage collective assets, prevent silos, and improve health and wellness outcomes.

*Maija Dyke, Business Manager/ R-CHIP Project Manager, Healthy Living for ME & Kathryn Harnish, Special Projects Manager/ R-CHIP Project Director, Aroostook Agency on Aging*

Thursday, November 9th, 8:30 AM - 9:30 AM

## Gateway

### **The Maine Rural GME Education (MERGE) Collaborative: An innovative, state-wide collaboration to address rural Physician recruitment**

The Maine Rural GME Education (MERGE) Collaborative is an innovative partnership of the 4 ACGME Sponsoring Institutions in Maine whose mission is to advance rural GME training across the state, develop a novel interprofessional rural curriculum, and a Rural Education and Leaders Academy to address healthcare inequities in rural Maine.

*Kalli Varaklis, MD, MEd, Designated Institutional Official MMC-MH, Principal Investigator MERGE Collaborative Grant*

### **Preparing Students to Enter Rural Practice Through the Use of Rural Healthcare Focused Objective Structured Clinical Examinations (OSCEs)**

Targeted case-based simulated patient encounters, or objective structured clinical examinations (OSCEs), where Physician Assistant (PA) students practice screening for and addressing rural health disparities in a supportive environment may increase students' comfort in managing encounters and addressing issues facing rural patients, and increase students' desire to enter rural health practice.

*Kristi Collins, MPAS Program Director and Associate Professor, Franklin Pierce Master of Physician Assistant Studies Program & Betsy Piburn, Director of Didactic Education, Franklin Pierce University*

## Escapade

### **Rural Hospital at Home: Lessons at the 1-Year Mark**

Hospital at Home isn't just for AMCs anymore. In this panel discussion, we'll reveal the highs, lows, and essential learnings from a groundbreaking H@H pilot in rural Kentucky. We'll share actual data on operations and outcomes as well as discussing strategic implications for other communities.

*Dawn Carter, Co-founder, Rural Healthcare Initiative & Joann Anderson, Trustee, Appalachian Regional Healthcare & Brian Springate, Community CEO, ARH Hazard Regional Medical Center*

## Ballroom

### **Recovery Ecosystems: What Are They, And How Can You Build One In Your Community?**

Recovery ecosystems provide environments where individuals can access substance use disorder treatment and recovery support services, such as housing and second-chance employment. This free, interactive tool incorporates an index to measure the strength of county-level recovery ecosystems and provides access to data to support community planning, programming, and technical assistance.

*Michael Meit, Director, East Tennessee State University Center for Rural Health Research, and Deputy Director for the ETSU/ NORC HRSA-funded Rural Health Equity Research Center*

### **A Community Approach to Caring for Patients with an Opioid Use Disorder in Long Term Care**

This session will present the importance of a community-based approach to support individuals with opioid use disorder, consider the learnings from the Massachusetts long term care program, and explore how existing tools and resources could be adapted for your community needs.

*Stephanie Baker MHA, CPHQ, Quality Improvement Manager, Healthcentric Advisors (HCA)*

Thursday, November 9th, 1:00 PM - 2:00 PM

## Northstar 1

### Taking Public Health Nursing Out of the Office and Into the Community

Public health nurses from a cooperative public health district in Franklin County, Massachusetts use innovative ways to serve the rural population in the communities where they live. Participants will consider the unique barriers to healthcare in rural areas and ways to provide public health nursing to vulnerable residents.

*Meg Ryan, Public Health Nurse, Franklin Regional Council of Governments*

### More than Celebrations: Improving Maternal Outcomes with Community Based Events: The Story of a Predominantly Rural County's Baby Shower

Berkshire AHEC hosted a county-wide baby shower in April 2023 that brought together approximately 50 vendors and service providers in the region in a single, stigma free access point. Attendees were able to talk to not only maternal health professionals, but mental health professionals, and learn about local public health initiatives.

*Joyce Brewer, Tobacco Free Community Partnership Program Manager, Berkshire AHEC*

## Northstar 2

### Centering Equity in Healthcare Emergency Preparedness: A Practical Approach from Vermont

Do you want to better serve your whole community? Do you want to know how to include equity into your emergency preparedness efforts? Do you want to know how to improve health outcomes during a disaster? If you answered yes to any of these questions, this session is for you.

*Amy Herron, Senior Planning Specialist, All Clear Emergency Management Group & Jenny Schmitz, Vice President, All Clear Emergency Management Group*

### Hep Free NNE 2023 Ending Hepatitis B and C In Northern New England

Hepatitis Free Northern New England ("Hep Free NNE") brings together stakeholders across Maine, New Hampshire, and Vermont to develop a plan for freeing NNE from viral hepatitis B and C. This tristate summit is part of a 2-year, community-driven strategic planning process aligned with national and global efforts to end viral hepatitis.

*Bronwyn Barnett, MPH, Viral Hepatitis Coordinator, New Hampshire Department of Health and Human Services & David de Gijzel, Medical Director NH/Department of Infectious Disease, Better Life Partners/Dartmouth Hitchcock*

## Gateway

### Achieving True Value-Based Care

This session will highlight a comprehensive approach to value-based care focused on interplay of medical care with the broad structural determinants of health and engage participants in sharing strategies and building relationships.

*Deborah Phillips, MS, IFNCP, Southern Berkshire Rural Health Network Director & Brian Burke, MD, Community Health liaison, South Berkshire Rural Health Network/Fairview Hospital*

### The Impact a Community Care Team (CCT) can have in a rural community

Starting a Community Care Team (CCT) can be just as exciting as it is overwhelming. Its results are undeniable, having multiple community partners coming together to help the neediest and at-risk clients in your area is wonderful.

Everyone discussing a reduction of emergency department visits, the stress on the healthcare system, and the toll that takes on everyone in the community is fantastic. Getting it together, finding the time, and getting buy-in... the struggle.

*Jason Kersten, Behavioral Health Program Director, Community Health & Wellness*

Thursday, November 9th, 1:00 PM - 2:00 PM

## Escapade

### Resilience Matters to ME: A Community Driven Messaging Campaign about Adverse Childhood Experiences

The process of translating research findings into clinical practice to improve population health is slow and inefficient, particularly in rural communities. Knowledge often does not reach the people who can benefit from it the most. Using Boot Camp Translation (BCT), an evidence-based method of partnering with community members as co-investigators to translate complex health information into locally relevant, actionable messages, a community group in Western Maine developed messaging on the topic of adverse childhood experience (ACEs) and resilience. 17 individuals with a broad array of lived experience participated in the 1.5 year process. The group developed 4 messages; 3 target everyone in the community and one targets parents and caregivers.

*Lisbeth Balligan, Research Program Director, MaineHealth Institute for Research & Emma DayBranch, Community Engagement Research Navigator, MaineHealth Institute for Research & Brendan Schaufler, Network Facilitator, Healthy Oxford Hills*

### Promoting Community-Research Projects and Partnerships: An Overview of Tools, Principles, and Navigation Support offered by the Northern New England Clinical and Translational Research Network (NNE-CTR)

Barriers for improving community participation and trust in science persist, preventing good science from becoming common practice. Yet researchers and community partners have much to offer each other in their work to reduce health disparities. This session provides actionable examples and methods to operationalize community-research partnerships.

*Emma DayBranch, Research Navigator, Northern New England Clinical and Translational Research Network & Carolyn Sullivan, Research Navigator, Northern New England Clinical and Translational Research Network & Nancy Kaplan, Research Navigator, Northern New England Clinical and Translational Research Network*

## Ballroom

### Rural Health and Community Transformation Utilizing Mobile Integrated Health

Creating a new rural "ecosystem" will be a critical step for many rural communities. Traditional approaches often focus on specific programs within their own sphere of expertise. Collaboration is frequently superficial, working around the edges with other community-based organizations. We are proposing a framework that necessitates non-traditional thinking and efforts.

*Janice, Walters, COO, Rural Health Redesign Center & Reuben Farnsworth, Community Paramedicine Subject Matter Expert, Independent Contractor*

### Socioeconomic Profiles and Market Characteristics Associated with Ambulance Deserts

Study objectives were to identify the socioeconomic profiles of populations within each of the 41 U.S. states that live in ambulance deserts (ADs), the extent to which at-risk vulnerable, aging populations live in ADs, and identify additional barriers to healthcare access.

*Yvonne Jonk, Associate Research Professor, Muskie School of Public Service, University of Southern Maine*

Thursday, November 9th, 2:30 PM - 3:30 PM

## Northstar 1

### Health Equity, Poverty, and Rural Resilience

This session will highlight health inequities in the New England states, present measures of prosperity to understand factors of risk and resilience, and highlight rural strengths to improve health and well-being. We will also introduce the CDC-funded Rural Health Mapping Tool, which serves as a resource to access county-level data.

*Michael Meit, Director, ETSU Center for Rural Health Research*

### SASH For All: Increasing equity in health and support coordination for adults and families living in affordable housing via expansion of the innovative SASH® (Support and Services at Home) model.

Adults and children living in poverty in rural areas experience health inequities and an opportunity gap. Learn how the SASH® model has expanded to decrease inequities not just with older adults but younger adults and families. Launched in the fall of 2022, there are lessons learned and initial data to share!

*Casey Doerner, SASH Assistant Director, SASH & Jake Bursky, SASH Coordinator for SASH for All, SASH & Barbara Carey, SASH for All Wellness Nurse, SASH*

## Northstar 2

### Equity: From Funding to Programming

When local and state funding sources tie dollars to health equity and collaboration, agencies build strong relationships among community partners and create programming aimed for vulnerable and underserved communities.

*Jamie Bentley, Community Impact Coordinator, Rutland Regional Medical Center & Arwen Turner, Executive Director, Come Alive Outside & Heather Brouillard, Partners for Prevention Coordinator, Rutland Regional Medical Center*

### When Public and Private Partnerships Center Community to Advance Health Equity

Two umbrella Nonprofit organizations chosen by the Vermont Department of Health share lessons learned in administering CDC funding to mitigate health disparities at the local level. Local community leaders who received grants will share their successes and challenges in addressing upstream determinants of health in their communities.

*Al Belluche, Program Officer, Vermont Community Foundation & Penrose Jackson, CEO Vermont Public Health Institute*

## Gateway

### Rural Health Care Outcomes Accelerator: Enhancing Cardiovascular and Stroke Care Quality in the Rural Setting

The Rural Health Care Outcomes Accelerator, a three-year initiative by the American Heart Association®, aims to eliminate rural health disparities by helping hospitals and clinicians provide high-quality, consistent, timely and appropriate evidence-based care.

*Mindy Cook, National Senior Director of Rural Health Care Quality, American Heart Association & Samantha Frederick, Program Consultant, Rural Health Care Quality, American Heart Association*

### Rural Perspectives on Needs in Childhood Brain Injury in Maine

To better understand the health and educational needs of children with TBI in Maine, a survey-based needs assessment and qualitative focus groups were conducted with stakeholders (e.g., caregivers, health/education professionals). Findings will be discussed related to interdisciplinary practices to improve outcomes for children with TBI from rural communities.

*Jessica Riccardi, Assistant Professor, University of Maine*

Thursday, November 9th, 2:30 PM - 3:30 PM

## Escapade

### Rural Telehealth: A Bridge Over Access Barriers

The COVID-19 pandemic ushered in an unprecedented rise in telehealth utilization in the United States. Many patients enjoyed the flexibility of seeing their doctor from a location of their choosing. This was of particular convenience for patients experiencing barriers to accessing in-person care, such as those with disabilities, limited access to transportation or those without paid sick leave from work. Audio-only telehealth bridged access barriers further by accommodating patients unable to utilize video telehealth, such as those with low digital literacy, limited access to broadband internet, concerns with self-image or fear of legal consequences such as undocumented immigrants or patients with active substance use. These issues are of particular concern in rural areas, where limited internet access and transportation are familiar challenges. With the COVID-19 pandemic winding down, there is mounting concern among providers that telehealth parity is on the chopping block, with audio-only potentially being the first to go. Loss of parity would reverse years of improvement in healthcare accessibility, particularly for the most vulnerable patients. We conducted a study to characterize the critical role of telehealth in Outer Cape Cod, a rural region with limited public transportation, the highest proportion of elderly individuals on the east coast north of Florida and a largely seasonal workforce. Seasonal workers may be faced with the cruel decision to attend an important medical appointment at the expense of a day's wage during peak tourist season. Telehealth offers a solution for these and many other patients struggling to see their provider. Our hope is that increasing awareness and understanding around these issues will contribute to efforts to maintain parity telehealth indefinitely.

*Zachary Strecker, UMASS CHAN Medical School*

## Ballroom

### The Covid Show: Stories from a Rural Community's Pandemic Resilience.

"The Covid Show" is a new play about navigating the pandemic as told through first person narratives. Presenters will discuss the process of creating the play, read selections from the script, and explore how they see theatrical performance as an advocacy tool for exploring community health issues.

*Carmela Lanza-Weil, Member, Special Projects, Buckland, MA BOH, Medical Reserve Corps of Franklin, Berkshire & Rebecca Daniels, Ph.D, Associate Professor Emerita, St. Lawrence University*

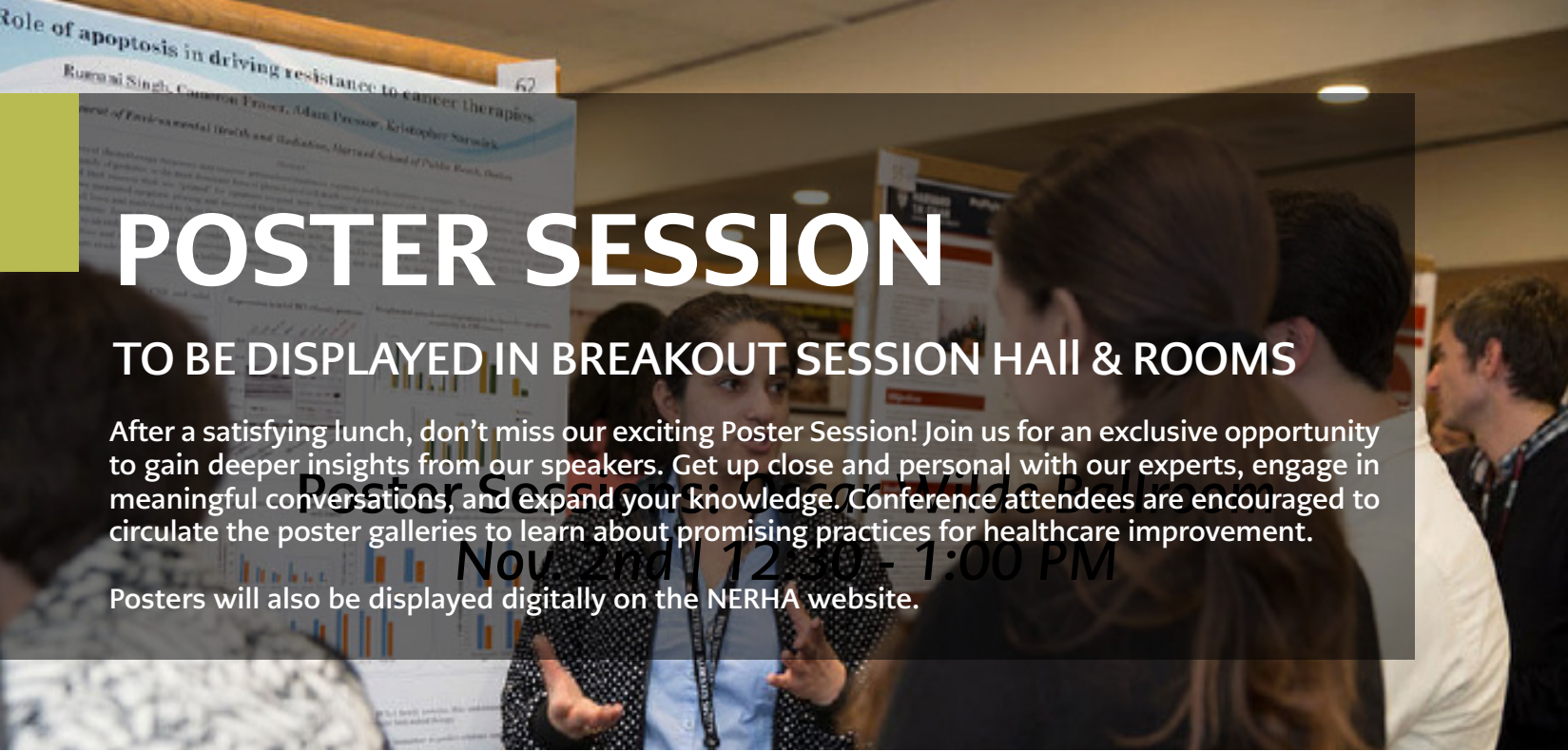

# POSTER SESSION

## TO BE DISPLAYED IN BREAKOUT SESSION HALL & ROOMS

After a satisfying lunch, don't miss our exciting Poster Session! Join us for an exclusive opportunity to gain deeper insights from our speakers. Get up close and personal with our experts, engage in meaningful conversations, and expand your knowledge. Conference attendees are encouraged to circulate the poster galleries to learn about promising practices for healthcare improvement.

Posters will also be displayed digitally on the [NERHA website](#).

Thursday, November 9th, 12:30 PM - 1:00 PM

**Health Equity Partnership of North Central Mass Inc | Chelsey Patriss**, Executive Director & **Rosa Fernandez**, Programs Director

**Dartmouth Hitchcock Medical Center | Sophia Allen**, Research Project Coordinator - OB/GYN & **Chelsey Canavan**, Manager of the DH Center for Advancing Rural Health Equity (CARHE)

**Health Promotion and Health Equity at Springfield College | Shannon Gifford**, Professor & **Olya Clark**, Director and Assistant Professor, **Educational Praxis and Springfield College**

**Dartmouth Hitchcock | Lori Fortini**, Program Leader

**SASH | Casey Doerner**, Assistant Director of SASH & **Kaileen Cruden**, SASH Fellow

**School of Nursing, The University of Maine | Colleen Marzilli**, Professor and Graduate Nursing Program Coordinator

**Island Health Care | Youxuan Wang**, IHC Practicum Intern from Boston University School of Public Health & **Brian Morris**, Mental Health / Substance Use Disorder Access Coordinator

**University of Massachusetts Chan Medical School | Grace Ryan**, Assistant Professor & **Maureen O'Reilly**, Health Educator and Epidemiologist, **Franklin Regional Council of Governments**

**Evernorth | Lindsay Thrall**, Connections Program Manager & **Margaret Maynard**, Capstone Coordinator, **University of Vermont**

## Poster Gallery

**Norwich University | Connie Hassett-Walker**, Presenter & Study PI, Assistant Professor

**Vermont Program for Quality in Health Care | Patrice Knapp**, Strategic Quality Improvement Consultant

**University of Connecticut | Eashwar Krishna**, Student

**The Dartmouth Institute for Health Policy and Clinical Practice | Kedryn Berrian**, Health Equity Research Fellow

**UMass Chan Medical School | Antony Tatar**, Medical Student

**Doxy.me | Asiyah Franklin**, Senior Telemedicine Success Manager

**Geriatric Center of Excellence at Dartmouth Health | Ann Osborn**, Clinical Research and Program Coordinator & **Chizuko Horiuchi**, Resource Specialist

**Community Nurse Connection | Donald Kollisch**, Board Chair, MD & **Sharon Morgan**, Board Member, RN

**Harvard Medical School Center for Primary Care | Hannah Schmitt**, Program Manager

**Dartmouth Health | Taralyn Bielaski**, Community Health Partnership Coordinator

**Dartmouth Health Connected Care | Keri Height**, Clinical Director/Clinical Psychologist

**Connecticut Department of Public Health | Justin Hamrick**, PCO Director & **Reeya Vora**, Yale Public Health Fellow

## MEMBER EXCHANGE

We have created a community platform to allow our members to take advantage of the collaborative opportunities [NERHA](#) can provide through our network. With [NERHA's Member Exchange](#) site, you can collaborate with peers to share strategic advice, solve challenges and develop new approaches that address your organization's rural health needs.



We have a variety of communities available for you to use to connect with your peers. The [Open Forum](#), [Student & Workforce Training Network](#), [Oral Health](#), etc. You can also make direct connections with others by region or profession, share resources and media, and a whole lot more!



Please visit our exhibitors and fill up your sheet to be entered to win a prize! Completed cards can be returned to the box at the registration table.

Name: \_\_\_\_\_

Email: \_\_\_\_\_

<b>BINGO!</b>	Northeast Telehealth Resource Center	Bicycle Health	Organogenesis
PatientPoint	Amerihealth Caritas	CareQuest Institute for Oral Health	Signify Health
Activate Care	Abbvie Pharmaceuticals	Sanofi	Harvard Pilgrim Health Care a Point32Health Company
The Medicus Firm	Janssen Neuroscience	Sano Health	New England Public Health Training Center
ArchProCoding	University of Massachusetts Chan Medical School	Gilead Sciences	Rural Medical Education Collaborative
University of New Hampshire Advanced Nursing Education Workforce	Wound Solutions	Henry Schein   Dentrax Enterprise	Millennium Health
Access Telecare	Collaborative Anesthesia Partners	Janssen Pharmaceuticals, Inc. - Mood Division	T2 Biosystems
Angel Flight East	Takeda Pharmaceuticals	VisualDx	New England Rural Health Association

## Bingo Card Game!

Yes, we know it's not EXACTLY a bingo card game (what with the need to fill all the squares) but we like to think that everyone out there is up to the challenge!

Be sure to check out all of our vendors and don't forget to grab a sticker while speaking with them. If you fill in all the squares and turn in your sheet to conference staff you will be entered to win one of two great prizes at the end of the conference!

## STAY CONNECTED

Stay in touch with [NERHA](#) and other attendees throughout the conference on Facebook and LinkedIn. Follow [NERHA @newenglandruralhealth](#) and use hashtag [#NERHA2023](#) to join the conversation.

# #NERHA2023

# THANK YOU!

Thank you to our conference planning & event volunteers! This year's event would not be possible without your participation. Interested in volunteering for next year's conference? Email us at: [admin@newenglandrha.org](mailto:admin@newenglandrha.org)

## Conference Committee

Danielle Fleury	Lori Fedewa
Veronica Roa	Susan White
Kirby Lecy	Yvonne Jonk
Lora Gerard	Cathleen McElligott

## Volunteers

Andrew Solomon	Reid Plimpton
Christopher Gilding	Zachary Strecker
Michaela Fascione	

## Staff

Andy Lowe	Jenn McCarthy
Ann Marie Day	LeeAnn Waye
Ezekiel Baskin	Aisling Ryan-Abbott
Kiera Hight	

## WOULD YOU LIKE TO GET INVOLVED AS WELL? CONSIDER JOINING A COMMITTEE!

### CONFERENCE PLANNING COMMITTEE

The Conference Committee is responsible for planning conferences held by NERHA, including the Annual Conference. The committee meets monthly and membership is open to all Association members.

### POLICY COMMITTEE

The Policy Committee is charged with the responsibility of proposing activities designed to increase the awareness of the needs of rural New England citizens and providers and reviewing policies, procedures, and legislation affected by these areas, making appropriate reports and recommendations to the Board of Directors.

### MEMBERSHIP & COLLABORATION COMMITTEE

The Membership & Collaboration Committee works to increase membership in the Association, explore new membership levels, and consider how external collaborative relationships can benefit the Association. Open to Association members.

### EDUCATION & WORKFORCE COMMITTEE

The Education Committee focuses on expanding student engagement/involvement in NERHA and expanding partnerships with a wide range of educational institutions. Goals include providing connections and opportunities to students, expanding cross-disciplinary learning opportunities, breaking down disciplinary silos, and providing workforce development. The Education Committee is open to all Association members.

### OUR PILLARS:

#### WORKFORCE CHAMPION

We will help expand, develop, and strengthen the rural health workforce.

#### VALUED PARTNER

We will develop impactful relationships with a broad partner base to further our mission.

#### BEST PLACE TO WORK

We will be an organization that attracts and retains top talent.

#### THOUGHT LEADER

Be recognized as the foremost authority in all areas of rural health; the "go-to" rural health organization.

#### TRUSTED CONVENER

We will serve as a regional convener to bring together diverse groups and partners for shared success.



## COVID-19 SAFETY - PUBLIC HEALTH IS OUR HIGHEST PRIORITY, SO WE ASK THAT YOU FOLLOW THE CURRENT CDC SAFETY MEASURES.

- The New England Rural Health Association recommends following current CDC guidance relating to COVID-19 and other infectious disease precautions. Please scan the QR code for the latest CDC COVID guidance.
- If you are more comfortable wearing a mask during the event, please feel free to do so. We will have a limited number of masks available.
- If you are sick or have symptoms of COVID-19 we ask that you please stay home.



THANK YOU FOR KEEPING EVERYONE SAFE AND HEALTHY!



# NERHA SUPPORTERS

## SPONSORS & VENDORS

We are profoundly grateful to our sponsors for their unwavering support at the 2023 New England Rural Health Association conference. Your generosity underpins the success of our event, highlighting our shared commitment to addressing rural healthcare challenges. Your sponsorship facilitates comprehensive programs, inclusive access, invaluable networking, and inspires collaborations, making this conference a beacon of knowledge and innovation. We look forward to continuing our partnership to enhance the health and well-being of rural New England communities. Thank you for your pivotal role in our success.

## Sprout Sponsors

Network of the National Library of Medicine, Region 7 | Post University | Burrows Consulting | UMMS-NEAETC | Boston University, School of Public Health | UNH Advanced Nursing Education Workforce and Institute for Health Policy and Practice | Mayo Clinic Cardiovascular Services | Chamberlain University & Walden University | Genentech | J&J/Janssen | Sanofi Pasteur | Healthcentric Advisors

## State Office of Rural Health Support

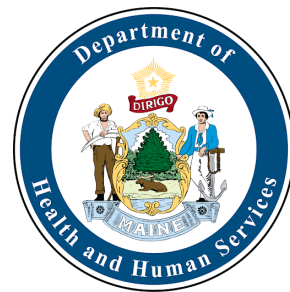

## Sapling Sponsors



The Northeast Telehealth Resource Center (NETRC) has a mission to increase access to quality health care services for rural and medically underserved populations through Telehealth. We provide FREE, individualized technical assistance, education, and other resources in collaboration with the Consortium of Telehealth Resource Centers, MCD Public Health, and the University of Vermont.



JSI is a mission oriented public health research and consulting company with several offices in New England and a long history of collaboration and support to the region's rural health care delivery systems at all levels.



The Medicus Firm is a national healthcare recruitment firm founded in 2001 with a mission to save lives through teamwork and the relentless pursuit of excellence. As one of the largest healthcare recruitment companies in the U.S., The Medicus Firm focuses on providing the most efficient and effective services to hospitals and healthcare employers nationwide.



AmeriHealth Caritas is one of the nation's leaders in healthcare solutions for those most in need. Operating in 13 states and the District of Columbia, AmeriHealth Caritas serves approximately 5 million Medicaid, Medicare, Children's Health Insurance Program (CHIP), and Health Insurance Marketplace. [www.amerihealthcaritas.com](http://www.amerihealthcaritas.com).



Gilead Sciences, Inc. is a research-based biopharmaceutical company focused on the discovery, development, and commercialization of innovative medicines. At Gilead, we set – and achieve – bold ambitions to create a healthier world for all people. From our pioneering virology medicines to our growing impact in oncology, we're delivering innovations once thought impossible in medicine.



GRAIL is a healthcare company, pioneering new technologies to advance early cancer detection. We have built a multi-disciplinary organization of scientists, engineers, and physicians and we are using the power of next-generation sequencing (NGS), population-scale clinical studies, and state-of-the-art computer science and data science to overcome one of medicine's greatest challenges.

The Northeast Telehealth Resource Center is proud to sponsor the 2023 New England Rural Health Association Conference.

**Do you need help implementing telehealth?**

We provide individualized technical assistance, education, and other resources in collaboration with the National Consortium of Telehealth Resource Centers, MCD Global Health, and the University of Vermont.

**We offer:**

- Short and long term technical assistance
- Access to specialized tools & templates
- Access to educational materials
- Education for the telehealth workforce
- Access to telehealth experts willing to share their experiences
- Monthly newsletter updates and other alerts on telehealth in the Northeast
- Support for collaboration that fosters a favorable environment for telehealth ...and more!



[www.netrc.org](http://www.netrc.org)



@NortheastTRC



[netrc@mcdph.org](mailto:netrc@mcdph.org)



**RSVP NOW!**



# 2023 NERHA FALL CONFERENCE

## STUDENT MIXER

November 8th, 4:30-5:30PM  
Killington Grand Resort Hotel

- Community
- Networking
- Group Activities
- ... and more!

CONTACT US • [ADMIN@NEWENGLANDRHA.ORG](mailto:ADMIN@NEWENGLANDRHA.ORG) • [NERHA.ORG](http://NERHA.ORG)

## Office of Rural Health & Primary Care



**Supporting  
health care  
infrastructure  
workforce  
quality  
and  
access to care  
in Vermont**

**Hospitals**

- Quality improvement
- Sustainability
- Population health

**Safety net services**

- Primary care
- Dental care
- Mental health

**Health care workforce**

- Data & maps for planning
- Shortage designations
- Recruitment incentives

**Rural health resources**

- Funding & partnerships
- National models
- Professional development

We are thrilled to extend a warm invitation to all students interested in rural health to attend our annual Fall Conference in November. Join us for a private student meet-up and networking event at the exquisite Killington Grand Resort Hotel, specifically at Preston's Restaurant & Bar. This is a fantastic opportunity to engage, socialize, and network with fellow students from schools of medicine, nursing, public health, and other programs across New England in a relaxed and welcoming atmosphere.



Date: Wednesday, November 8th Time: 4:30 PM - 5:30 PM Location: Killington Grand Resort Hotel - Preston's Restaurant & Bar

Whether you're a seasoned conference attendee or a first-time participant, this gathering promises to be a highlight of the event. It's a chance to connect with peers, share experiences, and foster meaningful relationships that can extend beyond the conference. Recent graduates will be on hand to give you the real story of what rural practice is like.

We look forward to seeing you at the Student Mixer and making this year's Fall Conference a memorable experience. If you have any questions or require further information, please feel free to contact us at [admin@newenglandrha.org](mailto:admin@newenglandrha.org)



WHY YOU SHOULD JOIN OUR NETWORK!

Our mission is to improve the health and wellbeing of communities throughout rural New England.

# NEW ENGLAND RURAL HEALTH ASSOCIATION

MEMBERSHIP BENEFITS FOR CONNECTION & SUCCESS

With an audience of more than 4,000 across six states

"The Association is my link to a larger rural health community, connecting me with the people and information I need to excel at my job."



## Networking

Grow your professional network with a member only virtual community, directory and our networking opportunities



## Education

Expand your skills and knowledge base by attending events and accessing our resources, webinars, and educational opportunities



## Students

Opportunities for presentation, comm. participation, access to rural health mentors, credit opportunities, volunteer activities and internships



## Access

To regional offices and federal level decision makers. Timely industry and government updates & opportunities to submit policy issues for joint action



## Discounts

Discounts for our large, annual, in-person conference



## Outreach

Promote to our 3000+ mailing list of professionals and increase your reach with monthly feature opportunities



# Membership Levels

## Annual Organization Membership

- Corporations - (up to 6 individuals receive benefits) - \$250
- Not For Profit Organization, Unlimited - (unlimited individuals receive benefits) - \$250
- Not For Profit Organization, 3 Employees - (up to 3 individuals receive benefits) - \$125

"The access we have gained to rural health leaders has been invaluable, leading to opportunities to learn about the rural healthcare sector and to engage with decision-makers."  
- Business Development Professional

## Annual Individual Membership

- Professional - \$50
- Student - \$10

"Through our participation in the organization, we have a regional partner for our state and national policy work. They make our voice louder."  
- Rural Hospital Program Coordinator

Education

Networking

Access

Collaboration

You can find more details on our membership benefits by going to our website as: [nerha.org/member-benefits-levels](http://nerha.org/member-benefits-levels)

# Killington Grand Resort Hotel & Conference Center

## Meeting Space Layout

- Breakout Sessions
- Check In Desk
- Plenary, Federal Panel, & Meals
- Sponsor Tables

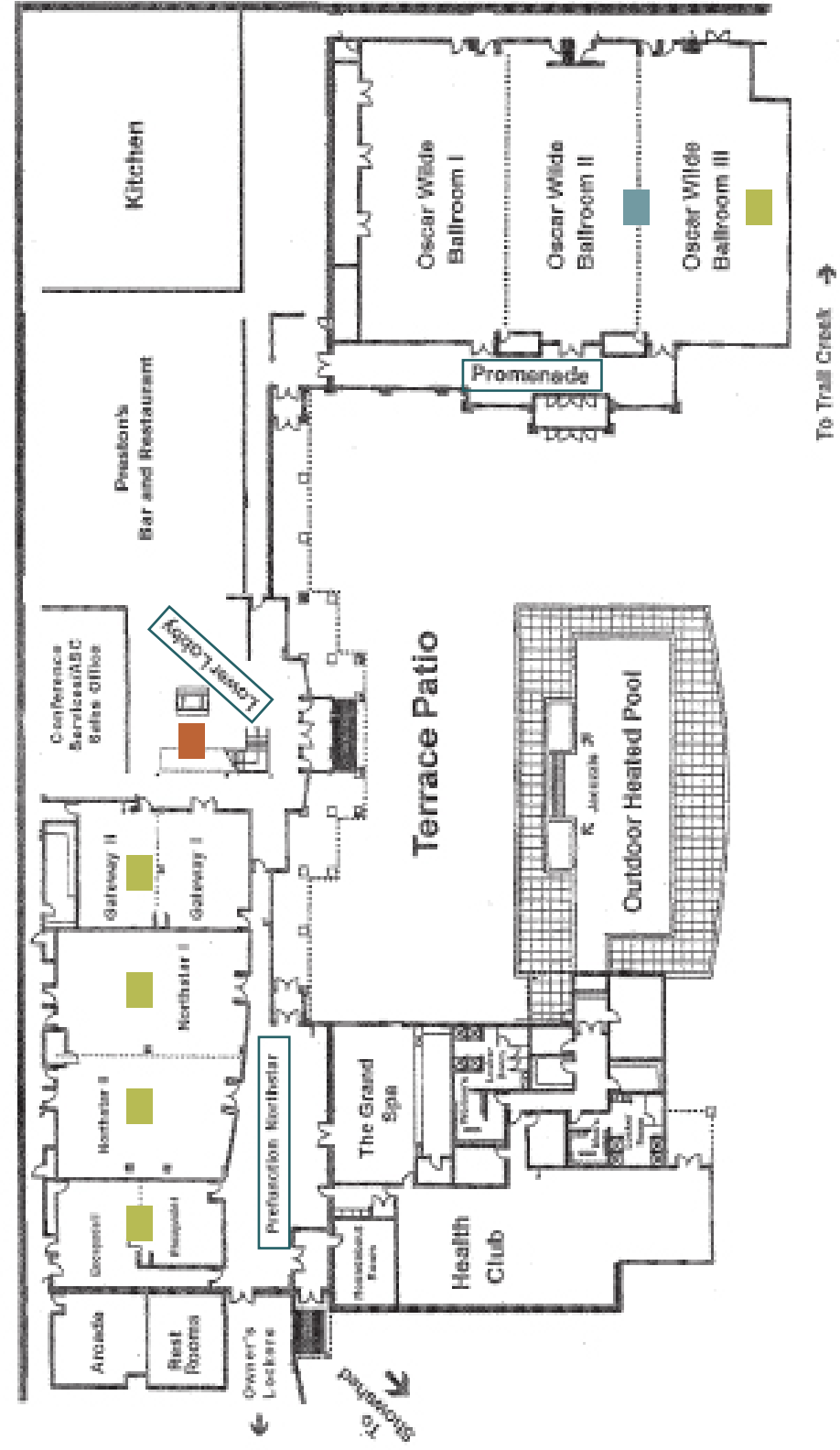

# NEW HORIZONS IN RURAL HEALTH EQUITY

## NERHA's 2023 Annual Fall Conference

Notes:

# Thank You For Attending!

The New England Rural Health Association  
[www.nerha.org](http://www.nerha.org)  
[admin@newenglandrha.org](mailto:admin@newenglandrha.org)

Join us on our Member Exchange!

